









MATCHMATE

The MATCHMATE range of radiator valves is ideal for use within central heating systems in the domestic housing market. They are available in a number of different models, including straight and angled, to suit varying specification requirements. All products feature impact resistant valve caps, providing highest quality at competitive prices. Drain off option also available on most products.

GENERAL SPECIFICATION

- 
CERTIFICATION
 Produced under a quality management system - ISO 9001:2008. Pressure tested in accordance with BS 2767.
- 
OPERATING PRESSURES
 Tested to a maximum pressure of 10 bar (compression), 3 bar (pushfit).
- 
GUARANTEE
 2 year guarantee from date of purchase against manufacturing defects.
- 
OPERATING TEMPERATURE
 Maximum 120°C (compression), 92°C (pushfit).
- 
COLOUR
 Finished in nickel or brass.
- 
DELIVERY
 2 - 5 working days.
- 
CONNECTIONS
 Compression or pushfit.

For more general information, please see page 276.

DIMENSIONS

Wheel Head

8/10/15mm Angle

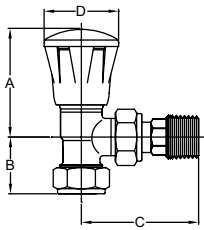

15mm Straight

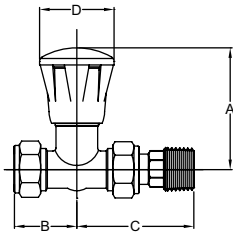

| Model | A | B | C | D |
|-----------------|------|------|------|------|
| | (mm) | (mm) | (mm) | (mm) |
| 8/10/15mm Angle | 54.0 | 28.0 | 58.0 | 37.0 |
| 15mm Straight | 60.5 | 30.5 | 58.0 | 37.0 |

Lockshield

8/10/15mm Angle with Drain Off

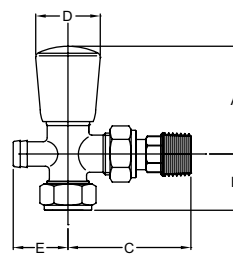

15mm Straight

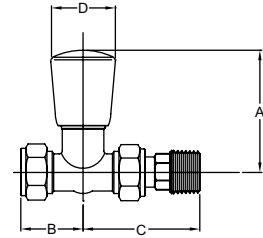

| Model | A | B | C | D | E |
|-----------------------|------|------|------|------|------|
| | (mm) | (mm) | (mm) | (mm) | (mm) |
| 8/10/15mm Angle/Drain | 54.0 | 28.0 | 58.0 | 32.2 | 28.0 |
| 15mm Straight | 60.5 | 30.5 | 58.0 | 32.2 | - |

NB: All measurements are nominal.



MM10LANPF90



MATCHMATE

| Description | Metal Finish | Wheel Head Order Code | Lockshield Order Code | Minimum Order Qty |
|--|---------------|-----------------------|-----------------------|-------------------|
| 8mm Angle | Nickel | MM8WAN | MM8LAN | 10 |
| 8mm Angle with Drain Off | Nickel | - | MM8LAND | 10 |
| 10mm Angle | Brass | MM10WAB | MM10LAB | 10 |
| 10mm Angle with Drain Off | Brass | - | MM10LABD | 10 |
| 10mm Angle | Nickel | MM10WAN | MM10LAN | 10 |
| 10mm Angle with Drain Off | Nickel | - | MM10LAND | 10 |
| 15mm Angle | Brass | MM15WAB | MM15LAB | 10 |
| 15mm Angle with Drain Off | Brass | - | MM15LABD | 10 |
| 15mm Angle | Nickel | MM15WAN | MM15LAN | 10 |
| 15mm Angle with Drain Off | Nickel | - | MM15LAND | 10 |
| 15mm Straight | Nickel | MM15WSN | MM15LSN | 10 |
| 10mm (90° Comp Elbow) Angle | Nickel | MM10WAN90 | MM10LAN90 | 20 |
| 10mm (90° Comp Elbow) Angle with Drain Off | Nickel | - | MM10LAND90 | 20 |
| Wheelhead Valve Top Only | White Plastic | MMTOPWH | - | 20 |
| Lockshield Valve Top Only | White Plastic | - | MMTOPLS | 20 |

MATCHMATE PUSHFIT



| | | | | |
|---|--------|-------------|--------------|----|
| 10mm Angle | Nickel | MM10WANPF | MM10LANPF | 20 |
| 10mm Angle with Drain Off | Nickel | - | MM10LANDPF | 20 |
| 10mm (90° Pushfit Elbow) Angle | Nickel | MM10WANPF90 | MM10LANPF90 | 20 |
| 10mm (90° Pushfit Elbow) Angle with Drain Off | Nickel | - | MM10LANDPF90 | 20 |
| 10mm Straight | Nickel | MM10WSNPF | MM10LSNPF | 20 |
| 15mm Angle | Nickel | MM15WANPF | MM15LANPF | 20 |
| 15mm (90° Pushfit Elbow) Angle | Nickel | MM15WANPF90 | MM15LANPF90 | 20 |
| 15mm (90° Pushfit Elbow) Angle with Drain Off | Nickel | - | MM15LANDPF90 | 20 |