



EV10LAN

EURO LOCKSHIELD

The Euro Lockshield is a lockshield valve designed primarily for TRVs and TRV packs. Lockshield valves help to keep the heating system balanced by controlling the flow of water, ensuring all radiators heat up at the same time. Euro Lockshield valves come in 10mm and 15mm sizes with drain off options available and are finished in nickel.

DIMENSIONS

Euro Lockshield

10/15mm Angle

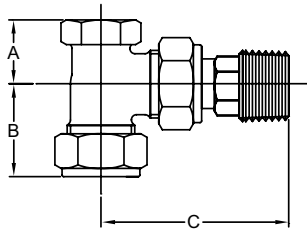

Model	A	B	C
	(mm)	(mm)	(mm)
10/15mm Angle	19.0	28.0	57.0

Euro Lockshield with Drain Off

10/15mm Angle

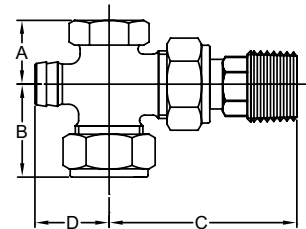

Model	A	B	C	D
	(mm)	(mm)	(mm)	(mm)
10/15mm Angle/Drain	19.0	28.0	57.0	23.0

NB: All measurements are nominal.

GENERAL SPECIFICATION



CERTIFICATION
Produced under a quality management system - ISO 9001:2008.



OPERATING PRESSURES
Tested to a maximum pressure of 10 bar. Pressure tested in accordance with BS 2767.



GUARANTEE
2 year guarantee from date of purchase against manufacturing defects.



OPERATING TEMPERATURE
Maximum 120°C.



COLOUR
Finished in nickel.



DELIVERY
2 - 5 working days.



CONNECTIONS
Compression.

For more general information, please see page 276.



EV10LAND

EURO LOCKSHIELD

Description	Metal Finish	Order Code	Minimum Order Qty
10mm Angle	Nickel	EV10LAN	10
10mm Angle with Drain Off	Nickel	EV10LAND	10
15mm Angle	Nickel	EV15LAN	10
15mm Angle with Drain Off	Nickel	EV15LAND	10