



Apple HomeKit technology provides an easy, secure way to control your home's lights, doors, thermostats, and more from your iPhone, iPad, or iPod touch. The Touch 2 Hub responds to Siri, letting you request the current temperature, set a new temperature or temperature hold and turn on/turn off standby directly from your iPhone, iPad, or iPod touch.

**Compatibility**  
 The Touch 2 Hub enables the Touch 2 WiFi to work with HomeKit technology. See [www.myson.co.uk](http://www.myson.co.uk) for more details.  
 To control this HomeKit-enabled accessory, iOS 9.3.2 or later is recommended. Controlling this HomeKit-enabled accessory automatically and away from home requires an Apple TV with tvOS 10.0 or later or an iPad with iOS 10.0 or later set up as a home hub.  
 Communication between the Touch 2 Hub and Touch 2 WiFi is secured by utilising frame-protection mechanism based on Advanced Encryption Standard (AES) with 128-bit randomly generated keys.  
 Communication between iPhone, iPad, or iPod touch and the HomeKit-enabled Touch 2 Hub is secured by HomeKit technology.  
 Use of the Works with Apple HomeKit logo means that an electronic accessory has been designed to connect specifically to iPod touch, iPhone, or iPad, respectively, and has been certified by the developer to meet Apple performance standards. Apple is not responsible for the operation of this device or its compliance with safety and regulatory standards. Apple, iPad, iPad Air, iPhone, and iPod touch are trademarks of Apple Inc., registered in the U.S. and other countries. HomeKit is a trademark of Apple Inc. Apple and the Apple logo are trademarks of Apple Inc., registered in the U.S. and other countries. App Store is a service mark of Apple Inc., registered in the U.S. and other countries.



## Want More Information?

Call our support team on: +44 (0)845 402 3434  
 Or view technical specifications directly on our website:  
[www.myson.co.uk](http://www.myson.co.uk)

### MYSON

Eastern Avenue, Team Valley,  
 Gateshead, Tyne & Wear NE11 0PG, UK  
 T: +44 (0)845 402 3434 F: +44 (0)191 491 7568  
[sales@myson.co.uk](mailto:sales@myson.co.uk) [www.myson.co.uk](http://www.myson.co.uk)

# Touch 2 Hub

(2nd generation)

Rev 1.1

## Setting Up Touch 2 Hub

Touch 2 Hub is designed to be quick and simple to setup.

Just follow the quick start set up sequence and you will soon have total control over your home heating system.

## System Requirements

- An active broadband connection.
- 230v mains supply (Adaptor supplied).
- A broadband router with DHCP function.
- A mobile device running iOS, Android or Windows Phone operating system.



## 1 Connect Power

Connect the power supply to the Touch 2 Hub.  
 Connect the Touch 2 Hub to the router with the Ethernet cable provided – the router will assign an IP address to the Touch 2 Hub.

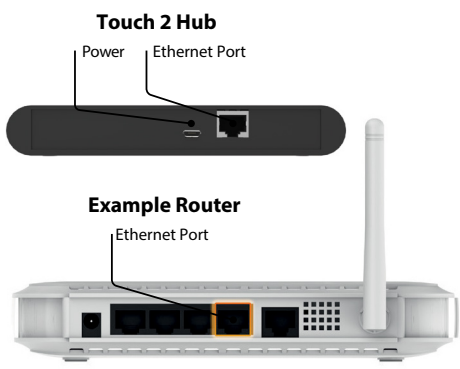

## 2 Download Application

Connect your mobile device to the same wifi network as your neoHub. Download the FREE Myson Touch 2 App and register your account.



## 3 Add Location

Once registered, select the add location option and follow the instructions.

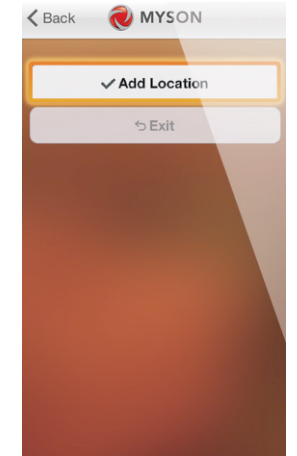
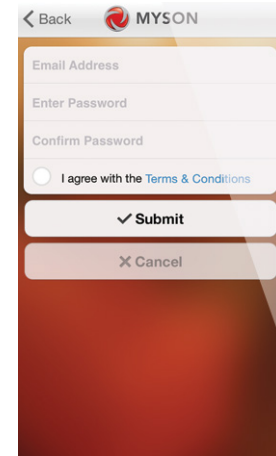

#### 4 Connect To Touch 2 Hub

Press the connect button on the Touch 2 Hub to add the Location to your Account.



#### 5 Name Your Touch 2 Hub

When successfully connected, add a title for the new location (e.g. Home) and configure the time zone for the system.

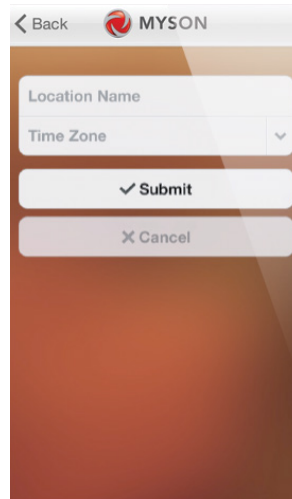

#### 6 Add Zone

The next step is to join Touch 2 WiFi Thermostats to the Touch 2 Hub. Select Add Zone in the Touch 2 App.

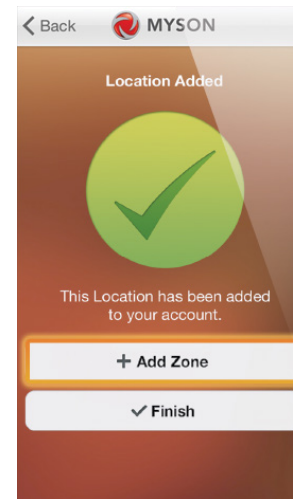

#### 7 Assign A Zone Name

You should now enter the name for this new zone and then press Add Zone.

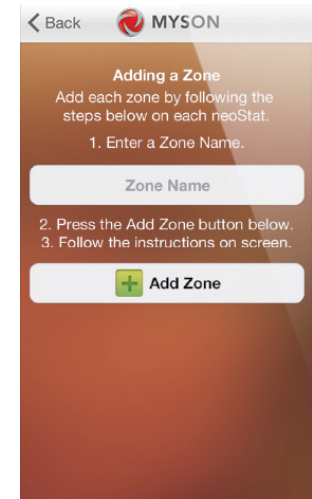

#### 8 Pair Your Touch 2 WiFi

On the Touch 2 WiFi, use the Left / Right keys to select SETUP and press Tick ..... <> ✓  
Feature 01 is displayed on screen.

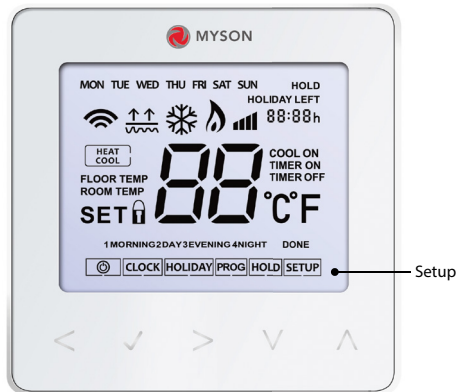

#### 9 Pair Your Touch 2 WiFi

Press the Tick key to pair the Touch 2 WiFi to the Touch 2 Hub ..... ✓  
The MESH symbol appears flashing on the display. ✓  
When the Touch 2 WiFi successfully connects to the Touch 2 Hub the MESH symbol will then be permanently displayed.

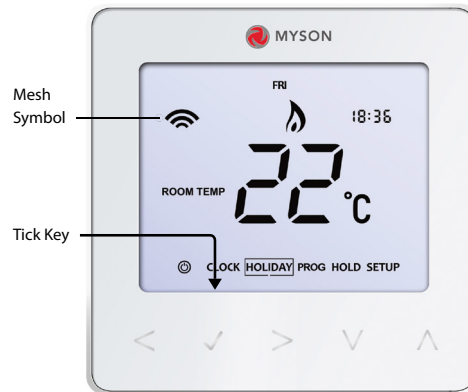

#### 10 Add Another Zone

When complete, press Next and repeat these steps for all additional zones on the network.

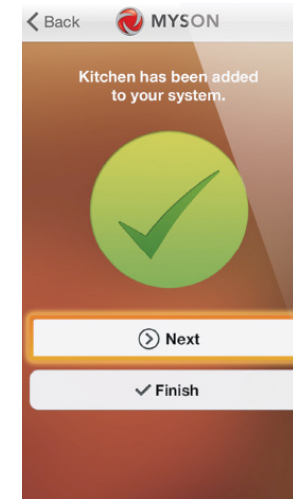

#### 11 Complete Setup

When all zones have been added, press Finish on the app to complete setup.

